

RUGGED COVER

17-19 Honda Ridgeline Rail Installation Instructions

200 Universal Dr. • Owosso, MI 48867 • 989-725-8354 • Fax: 989-725-8409 • 1-800-433-3604

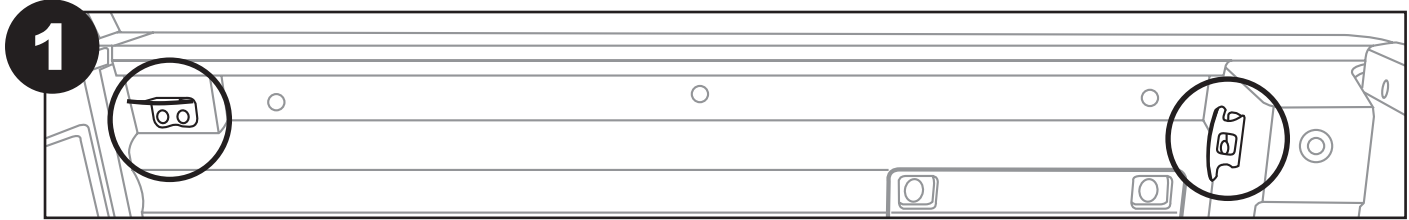

1. Remove the 4 upper tie-down hooks with T50 Torx driver. Keep the 8 torx bolts, but do not reuse the tie-down hooks.

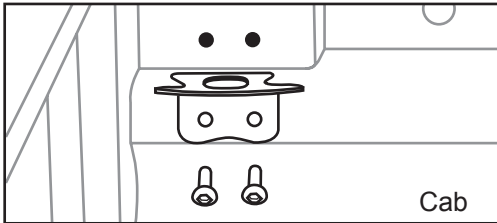

Front upper tie-down hooks on both sides

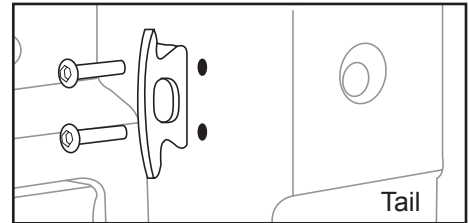

Rear upper tie-down hooks on both sides

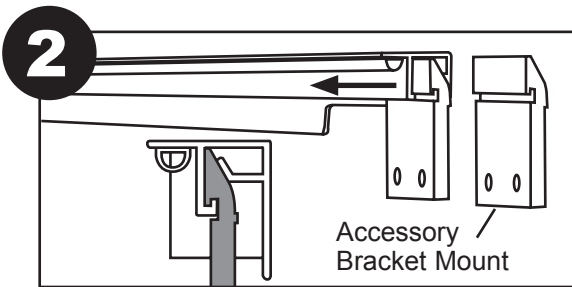

2. Slide two of the accessory bracket mounts into each rail. Align with the rail interior profile as shown.

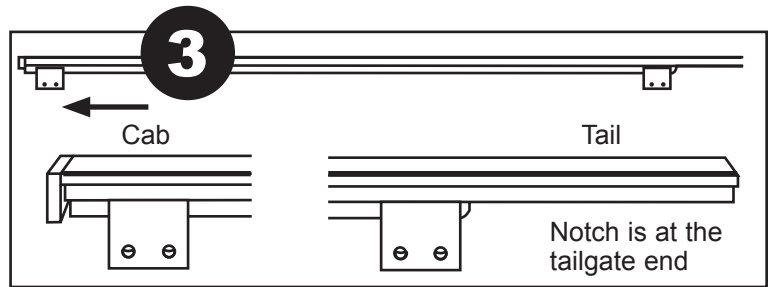

3. Slide one of the accessory bracket mounts to the front leaving the other at the tailgate end of the rail.

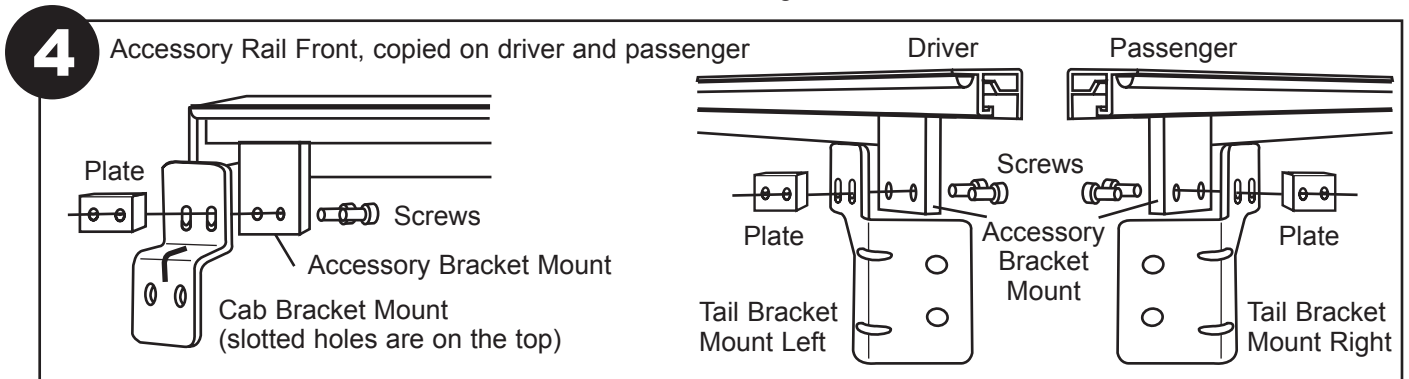

4. With the accessory bracket mounts slid into the rails, assemble the brackets as shown. Loosely tighten screws.

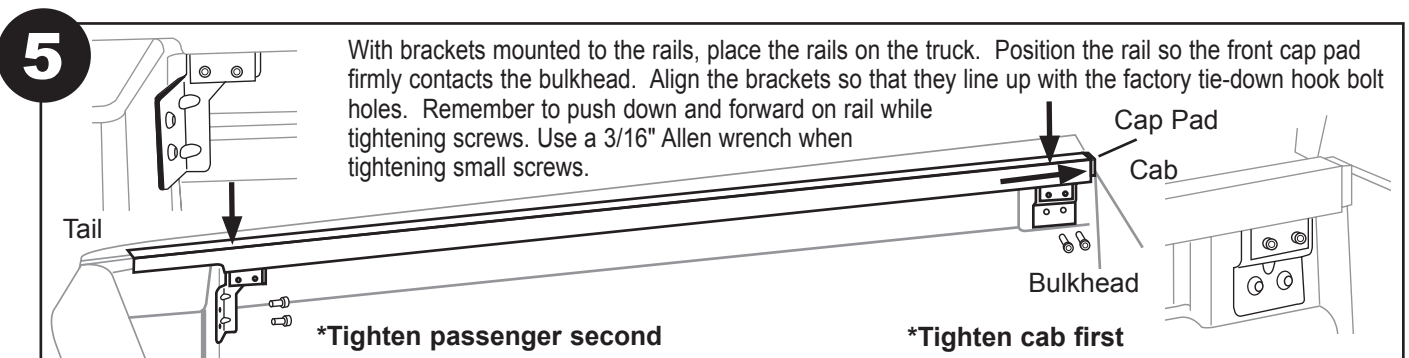

With brackets mounted to the rails, place the rails on the truck. Position the rail so the front cap pad firmly contacts the bulkhead. Align the brackets so that they line up with the factory tie-down hook bolt holes. Remember to push down and forward on rail while tightening screws. Use a 3/16" Allen wrench when tightening small screws.